

# HOW TO BUILD A TRANSITIONAL SHELTER

अस्थायी भवन निर्माण गर्ने तरिका।



## PRE WORK / पूर्व कार्य

DAY  
1

- Announce the project
- Gather any villagers that want to build and learn to build
- Explain that the purpose is to invite everyone that wants to learn new building techniques to help and reproduce these ideas in their home construction project

- सर्वप्रथम परियोजनाको घोषणा गरौं
- निर्माण गर्न र निर्माण गर्न सिकन इच्छुक गाउँलेहरूलाई भेला गराऔं
- यी नयाँ भवन निर्माण प्रविधि सिकेर आभनो घर निर्माणमा उतार्न र साथै अरुलाई मदत गर्न इच्छुक सबैलाई हामी आमन्त्रित गर्छौं भनेर बुझाऔं।

1

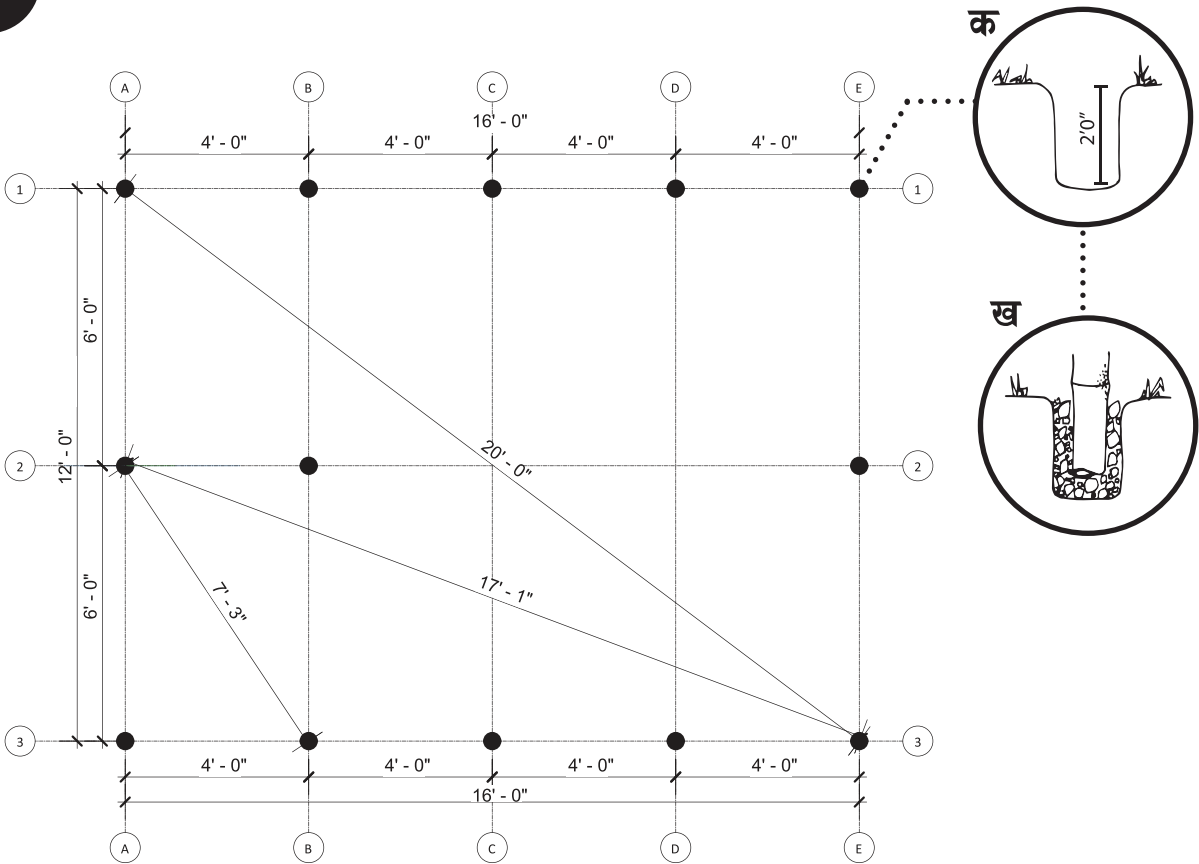

## MEASUREMENT + DIG A PIT/ नाप + खल्डो खन्ने

- Make sure you have a clear site, measured as per drawing.
- Clear away any items that may be blocking a clean worksite.
- Place pegs and thread to mark measurement as per drawing.
- Dig 2' deep holes at the indicated intervals.

- नक्सा बमोजिम मापन स्पष्ट जग्गा निश्चित गरौं।
- जग्गामा कुनै पनि अनावश्यक वस्तुहरू भए हटाऔं।
- किल्ला र धागोले नक्सा अनुसार मापन चिनो बनाऔं।
- नक्सामा उल्लेखित ठाउँमा २ फीट गहिरो प्वाल खनौं।

## INSTALL THE POST / खामा गाडने

2

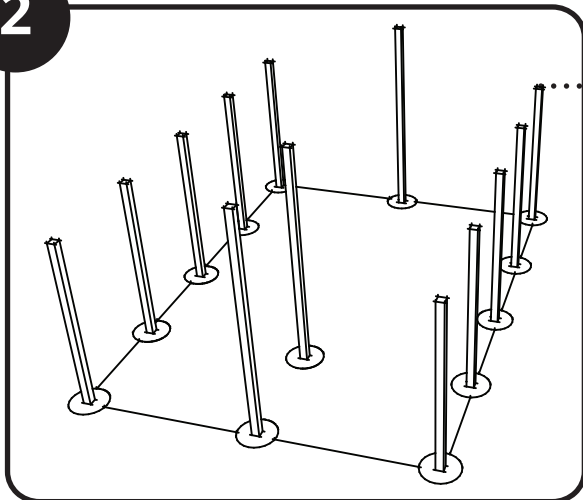

क

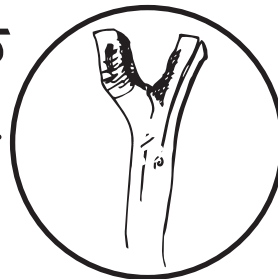

ख

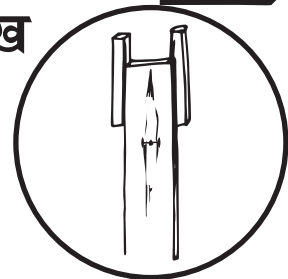

ग

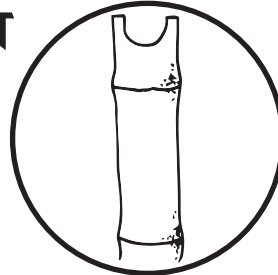

घ

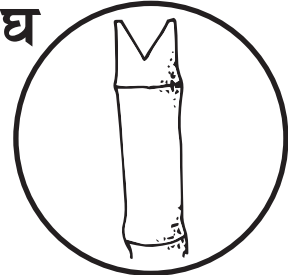

- Place post of 10' for the middle pillar and 8' for the sides.
- Make sure 2' goes underground
- Ram them into the ground as sturdy as possible with a rock

- बीचमा १० फीटको खामा र दायाँ बायाँ ८ फीट कोखामा राखौं।
- ति खामा निश्चित २ फीट जमिन मुनि जाने बनाऔं।
- ढुंगाले खामलाई जमिन तिर ठोकेर सके सम्म मजबूत बनाऔं।

## INSTALL THE BEAMS / बलो राखने

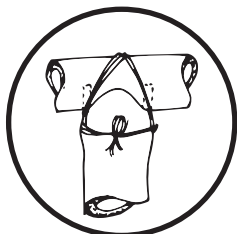
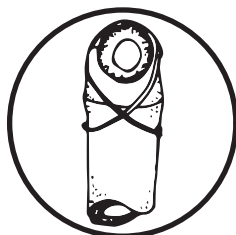

3

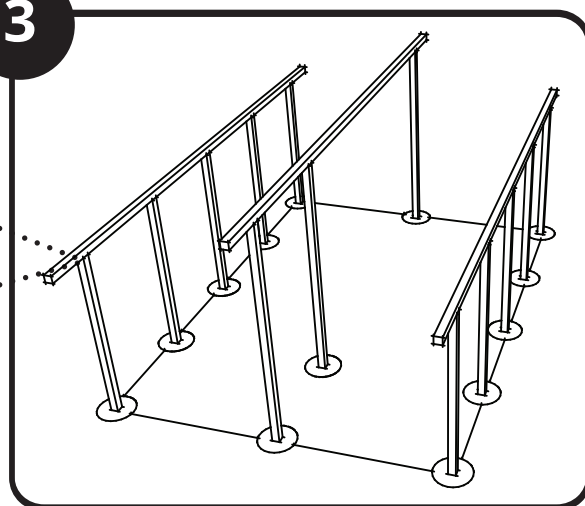

- Lay horizontal beams across the columns and bind them together with wire and nails.

- तेर्सो बलो खामा उपर राखेर तार र किल्लाले बाँधौं।

## TIE THE RAFTERS / डाँडाँ भाटो राखने

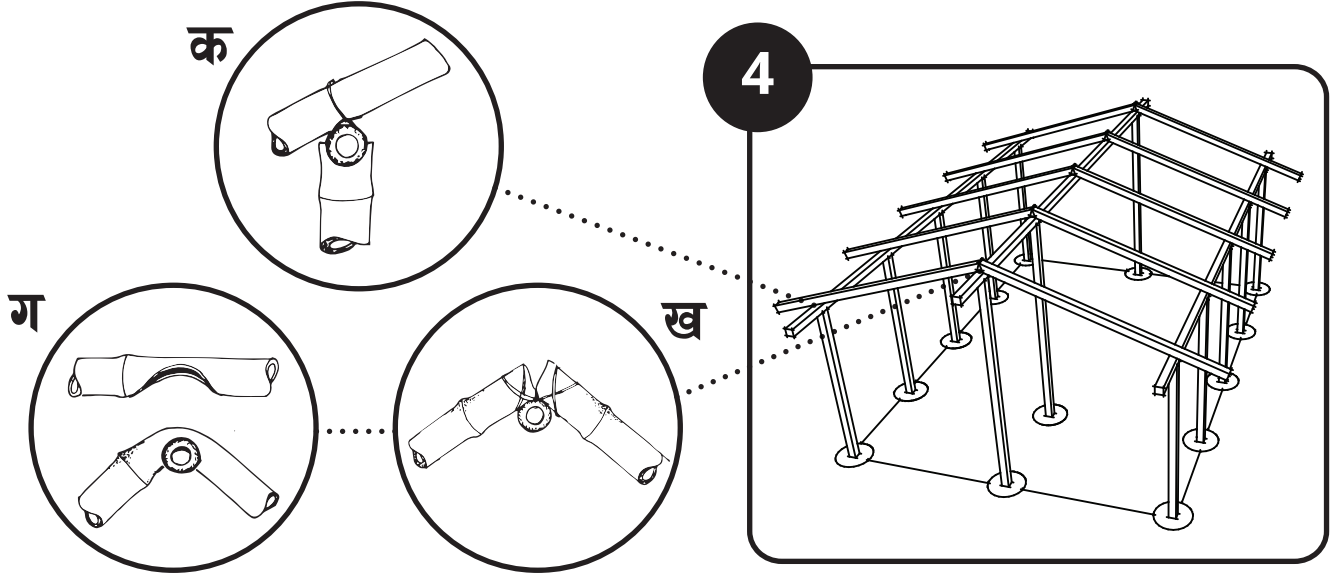

- Place rafters and tie them to the post with wire

- डाँडाँ भाटोलाई नक्सा अनुसार राखौं र खामासित तारले बाँधौं।

## TIE THE PURLIN / सेप्टी राखने

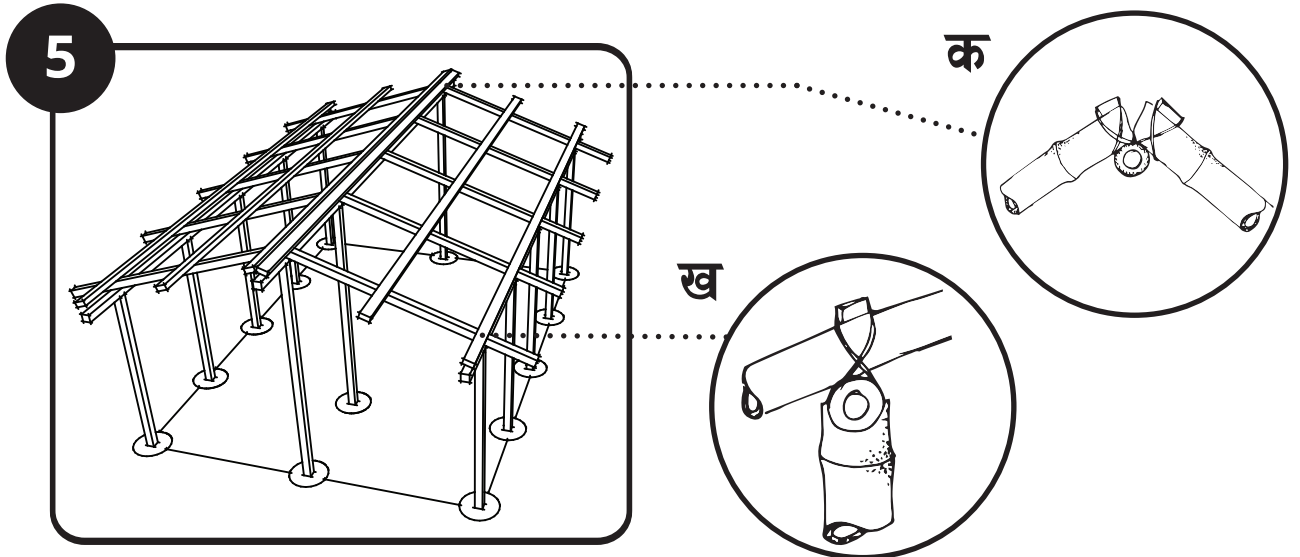

- Place purlin and tie them to the rafter with either nails or wire at appropriate intervals.

- सेप्टीलाई नक्सा अनुसार राखौं र डाँडाँ भाटोसित उपयुक्त अन्तरलमा किल्ला अथवा तारले बाँधौं।

6

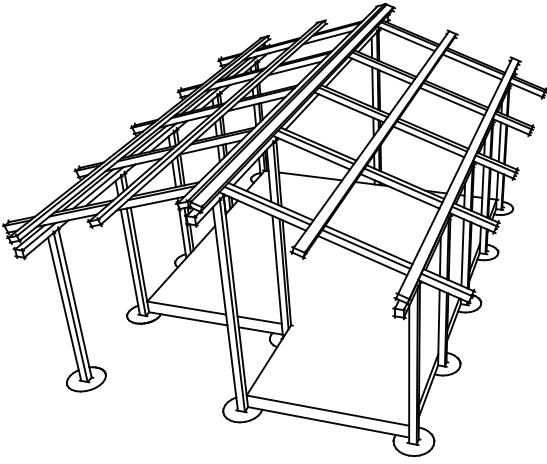

## FLOORING / भुइँ

DAY  
2

- Use the mud excavated from the site in order to bring the whole floor of the home 6" up
- Place a damp proof membrane on top to prevent seepage
- जग्गाबाट खनेर निकालेको माटो प्रयोग गरि घर भित्रको भुइँ ६ इन्ची अग्लो बनाऔं
- तेस्को माथी नमीबाट बचाउने पत्र राखौं

## WALL CHOICES / भित्ताको विकल्प

DAY  
2/3

7

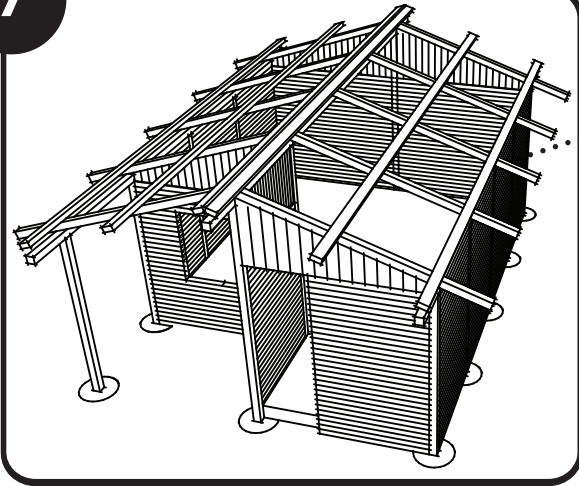

क

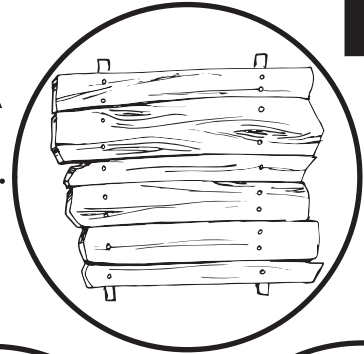

ख

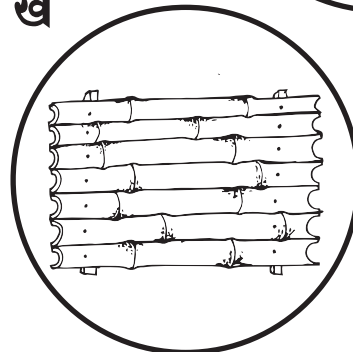

ग

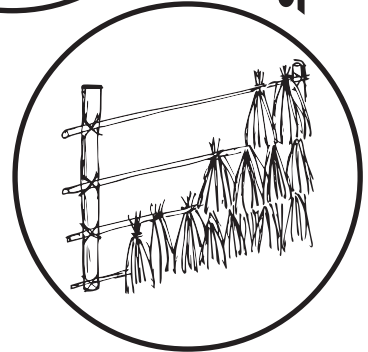

- Prior to working on the walls make sure the windows, doorframes, etc are lined up
- Materials that owner wants to build with are at the site.
- Avoid placing corrugated iron on the south side of the home at all costs, it will not be habitable during summer.

- भित्तामा काम सुरु गर्न अघि झ्याल र ढोका ल्याऔं घरमालिकले चाहेको निर्माण गर्ने।
- सामग्री जग्गामा ल्याएको सुनिश्चित गराऔं।
- दक्षिण दिशामा जस्तापाता नराखौं स राखे गर्मीयाममा बस्न उपयुक्त हुदैन।

8

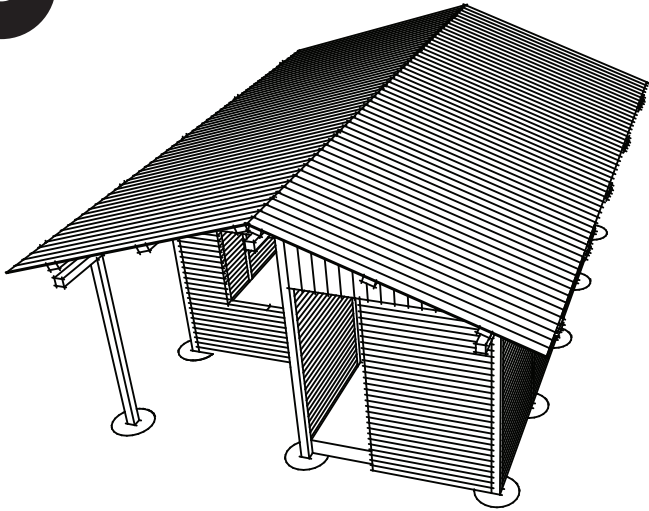

- Place CGI sheet with 3" overlaps between two adjacent sheets
- Make sure there is overhang on all sides to prevent the rain from coming in.
- Nail the CGI sheet exactly on top of the purlin.

- छानामा जस्तापाता राखौं।
- दुई जस्तापाता बीचमा २ इन्च खटाउँ र बाछिट्टा नछिर्ने गरि वरिपरि छाज्जा राखौं।
- जस्तापातालाई ठीक सेप्टिको माथी किल्लाले ठोकौं।

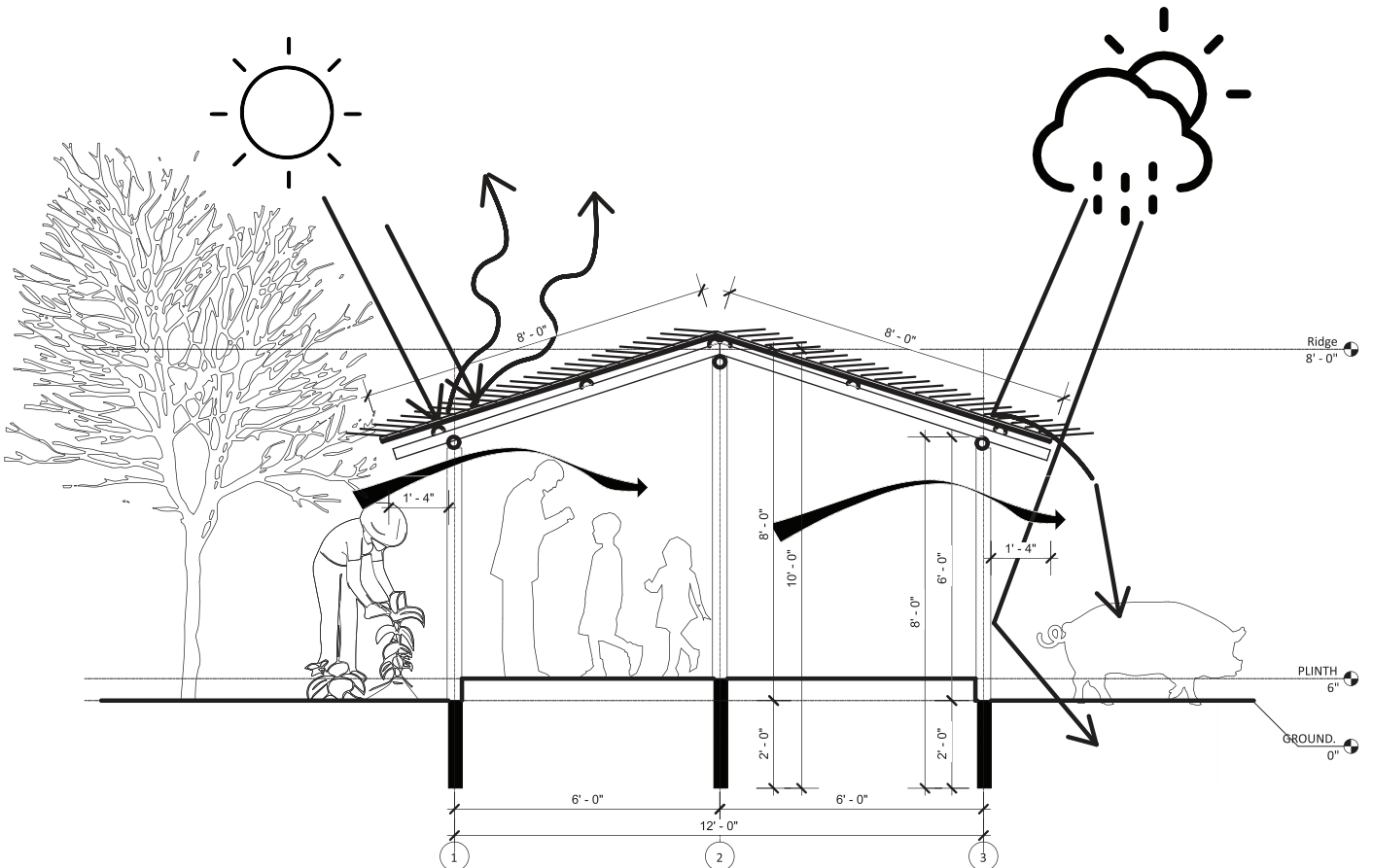

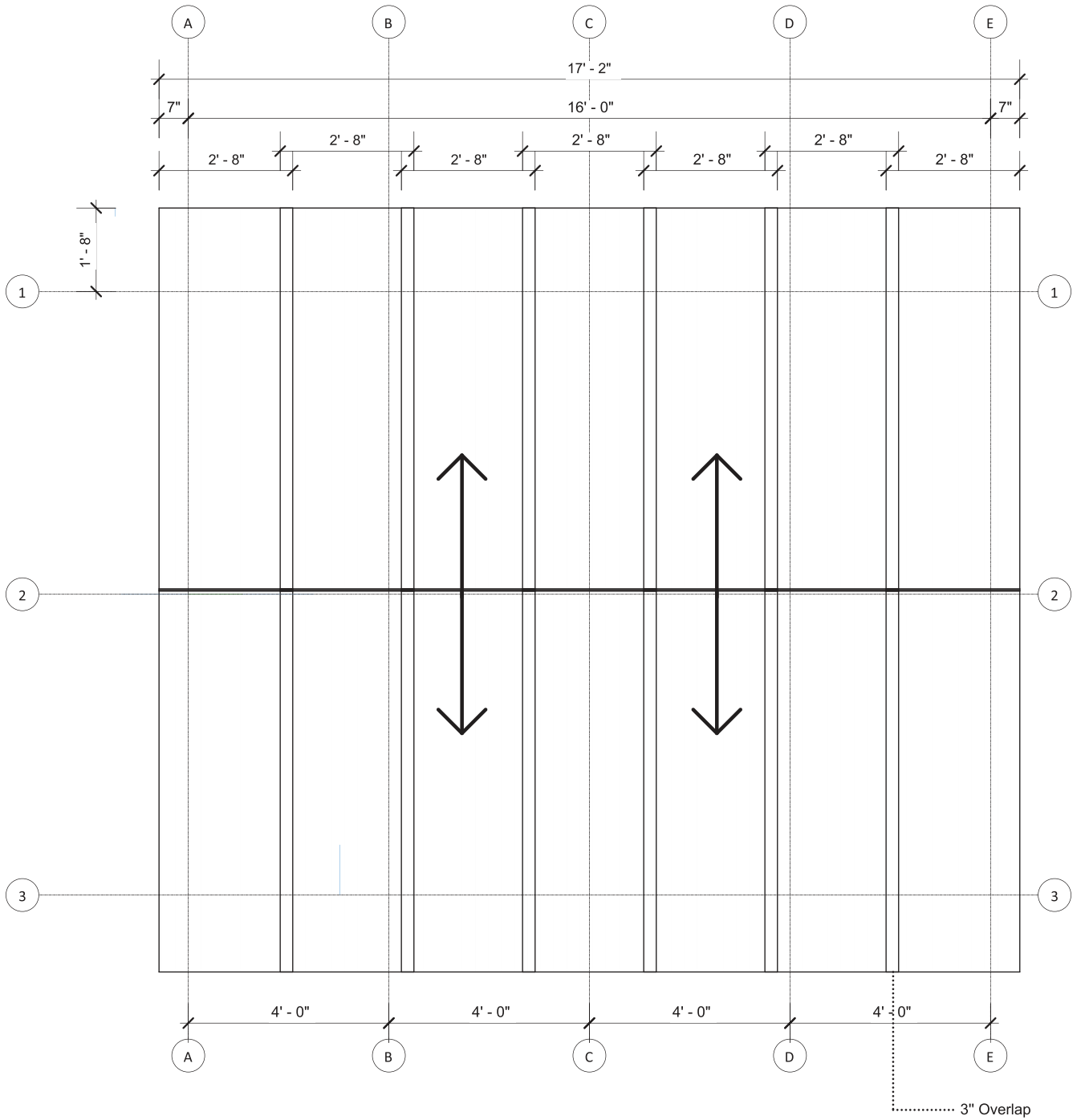

- While workers are on the roof, nailing the galvanized iron in place, work simultaneously on the walls
- Cut old planks, split bamboo, etc.

- छानामा काम हुँदै गर्दा भित्ताको काम थालौं।
- काठ काट्ने र बाँस चिर्ने आदिइत्यादी गराऔं।

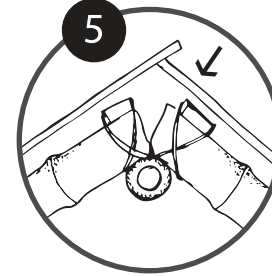
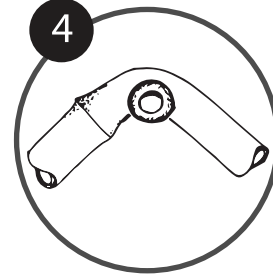
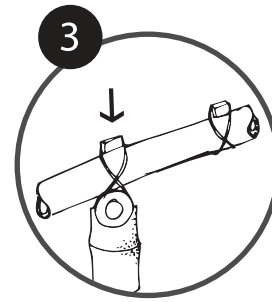
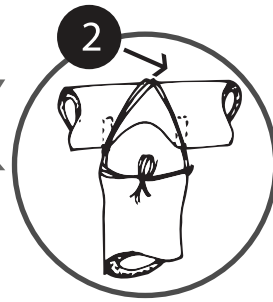

- 1 **Post / खामा**  
8'x10 Pcs  
10'x 3 Pcs
- 2 **Beam / बलो**  
17'x 3 Pcs
- 3 **Purlin / सेटी**  
17'x 4 Pcs
- 4 **Rafter / डाँडा भाटो**  
16'x 5 Pcs
- 5 **CGI / जस्ता**  
8'x 14 Pcs

## OTHER STEPS TO FOLLOW: अन्य पालना गर्नुपर्ने कुराहरू

- Day 1 – make sure you water the rammed part around the post to gain stability
- Day 3 – After completion of the walls, if possible plaster them with cow dung/ mud
- For the flooring, the owner can either use salvaged slates or cow dung.

- पहिलो दिन : खामाको वारीपरी ठोकेको ठाउमा बलियो बनाउन पानीले छयापौं।
- तेस्रो दिन : भित्ता बनाउन पूर्ण भएपछि सके त्यसमाथी गाईको गोबर अथवा माटोको लेप लगाऔं।
- भूईको लागि घरमा लिकले गाईको गोबर अथवा ढुंगाको प्रयोग गर्न सक्छ न

DESIGN / CONCEPT

**बाबारी | abari**  
bamboo and earth initiative

W: [www.abari.org](http://www.abari.org) | E: [info@abari.org](mailto:info@abari.org) | P: +977 9849 00 38 76

MEDIA PARTNER  
(Designed and compiled by)

**सत्या**  
MEDIA ARTS COLLECTIVE KTM.

W: [www.sattya.org](http://www.sattya.org) | E: [collective@sattya.org](mailto:collective@sattya.org) | P: 01 5523 486